

PHYSICAL SPECIFICATION

| | | |
|------------------------|------------------|--|
| Nominal Voltage | | 12V |
| Nominal Capacity(10HR) | | 150AH |
| Dimension | Length | 496±2mm (19.53inches) |
| | Width | 205±2mm (8.07inches) |
| | Container Height | 207±2mm (8.15inches) |
| | Total Height | 241±2mm (9.49inches) |
| Weight | | Approx 54Kg (118.9 lbs) |
| Standard Terminal | | B3(Bolt & nuts Terminal) Bolt Type:M8 |

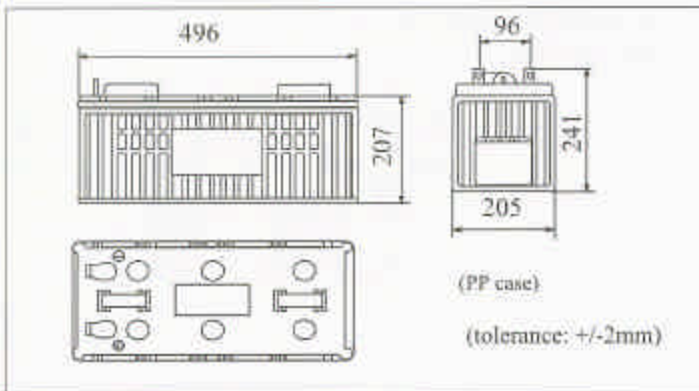

B3 (Bolt-and-nut lead terminal)
Bolt Type: M8

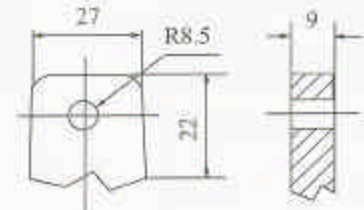

ELECTRICAL SPECIFICATION

| | | | | | | | | |
|----------------------------------|---------------------------------------|--|---|-------------------------|--|--|---------|--|
| Capacity | 20 hour rate(7.5A) | 157.5Ah | <p>It is recommended to use constant-voltage charge and recharge immediately after use</p> <table border="1"> <tr> <td rowspan="2">Constant-Voltage Charge</td> <td>Cycle</td> <td>Initial Charging Current less than 37.5A Voltage 14.1V-14.4V at 25°C (77°F) Temperature Coefficient -18mV/°C</td> </tr> <tr> <td>Standby</td> <td>No limit on Initial Charging Current Voltage 13.5V-13.8V at 25°C (77°F) Temperature Coefficient -18mV/°C</td> </tr> </table> | Constant-Voltage Charge | Cycle | Initial Charging Current less than 37.5A Voltage 14.1V-14.4V at 25°C (77°F) Temperature Coefficient -18mV/°C | Standby | No limit on Initial Charging Current Voltage 13.5V-13.8V at 25°C (77°F) Temperature Coefficient -18mV/°C |
| | Constant-Voltage Charge | Cycle | | | Initial Charging Current less than 37.5A Voltage 14.1V-14.4V at 25°C (77°F) Temperature Coefficient -18mV/°C | | | |
| Standby | | No limit on Initial Charging Current Voltage 13.5V-13.8V at 25°C (77°F) Temperature Coefficient -18mV/°C | | | | | | |
| | 10 hour rate(15A) | 150Ah | | | | | | |
| | 5 hour rate(25.5A) | 127.5Ah | | | | | | |
| | 3 hour rate(37.5A) | 112.5Ah | | | | | | |
| | 1hour rate(90A) | 90Ah | | | | | | |
| Capacity affected by temperature | 40 °C (104°F) | 102% | | | | | | |
| | 25 °C (77°F) | 100% | | | | | | |
| | 0 °C (32°F) | 85% | | | | | | |
| Internal Resistance | Fully charged battery(25 °C, 77°F)3mΩ | | | | | | | |

